



KRUPPSMETAL



Kruppsconduit

Metal Raceway Product Range

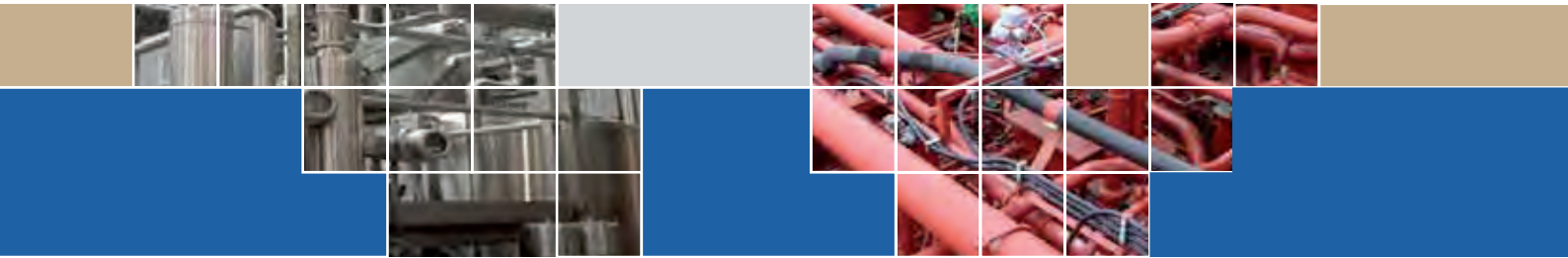

FLEXIBLE CONDUITS

Flexible conduits are used to connect to motors or other devices where isolation from vibration is useful, or where an excess number of fittings would be needed to use rigid connections. Electrical codes may restrict the length of a run of some types of flexible conduit.

Flexible metallic conduit used in an underground parking facility.

Flexible Metallic Conduit (FMC, often informally called greenfield or flex) is made by the helical coiling of a self-interlocked ribbed strip of aluminum or steel, forming a hollow tube through which wires can be pulled. FMC is used primarily in dry areas where it would be impractical to install EMT or other non-flexible conduit, yet where metallic strength to protect conductors is still required. The flexible tubing does not maintain any permanent bend.

FMC may be used as an equipment grounding conductor if specific provisions are met regarding the trade size and length of FMC used in addition to the amperage of the circuits contained in the conduit. In general an equipment grounding conductor must be pulled through the FMC with an ampacity suitable to carry the fault current likely imposed on the largest circuit contained within the FMC.

Liquidtight Flexible Metal Conduit (LFMC) is a metallic flexible conduit covered by a waterproof plastic coating. The interior is similar to FMC.

Flexible Metallic Tubing (FMT) is not the same as Flexible Metallic Conduit (FMC) which is described in National Electrical Code (NEC) Article 348. FMT is a raceway, but not a conduit and is described in a separate NEC Article 360. It only comes in 1/2" & 3/4" trade sizes, whereas FMC is sized 3/8" to 6" trade sizes. NEC 360.2 describes it as: "A raceway that is circular in cross section, flexible, metallic and liquidtight without a nonmetallic jacket."

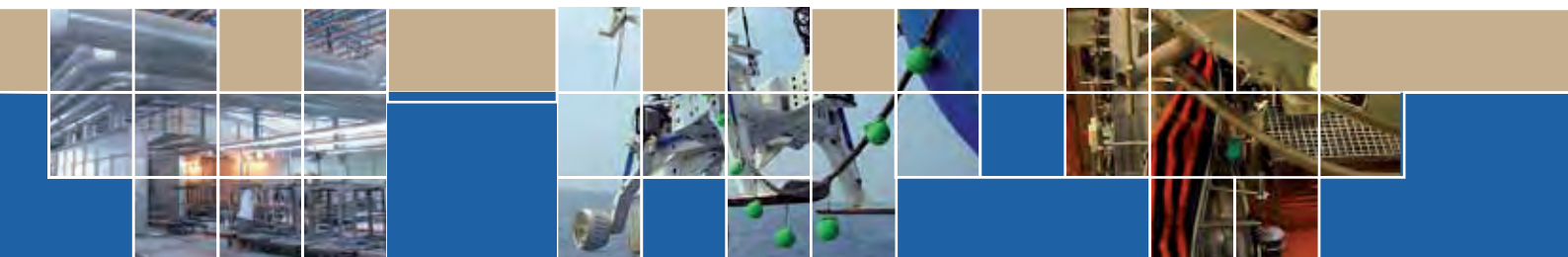

Flexible Metallic Conduit (**KF-1703**)

Flexible steel conduit has many universal wiring applications. This conduit can withstand substantial impact and crushing forces.

- Flexible metal conduit with square locked or interlocked construction of galvanized steel strip
- Good mechanical protection of wirings
- All metallic constructions, inherent low fire hazard
- Trade size - 1/4" to 6" & 16mm to 50mm
- Temperature -40° to 90°C
- **For overall steel braid please look into our KF-1701 series**

Features:-

- Hot Dipped Galvanized zinc coating surface finish
- Corrosion Resistant
- Smooth inner finish for easy wiring installation
- **Available in cut length fixed with connectors as per the clients request.**

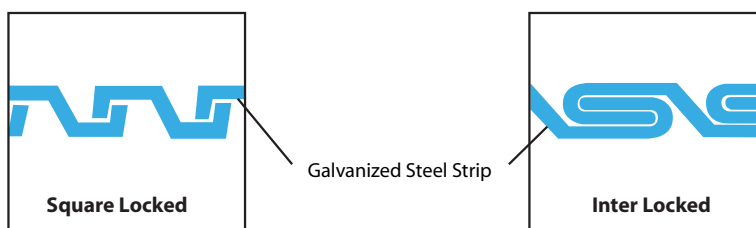

Constructed by square locking or interlocking galvanized steel strip:

- Flexible metal conduits offer good mechanical protection to wiring in a variety of O.E.M. applications.
- With excellent flexibility characteristics with the square locked construction. The interlocked construction provides increased mechanical strength.
- All metallic constructions, inherent low fire hazard

Applications:

- Industrial wirings, appliances, automotive wire & cable sleeving, machineries, electric wire flexible conduits
- It can also be used as a protective cover in industrial environments for hydraulic lines, brake lines, power steering assemblies, and wiring harness etc.

Flexible Galvanized Steel Conduit is suitable for concealed, exposed, or approved raceways. The flexible conduit is manufactured with a spiral wound strip of corrosion and rust resistant, electrogalvanized steel. The conduit features a smooth metal interior for easy wiring pulling. The flexible steel conduit is wire temperature rated, and has superior crush-proof qualities.

Square Locked	Inter Locked	Metric Thread	Trade Size	I.D. (mm)		O.D. (mm)		Min. Bending Radius (mm)	Feet / Coil
				Min.	Max.	Min.	Max.		
KFSL-1025	KSIL-1025		1/4"	9.7	10.2	13.5	14.0	40	100
KFSL-1030	KSIL-1030		3/8"	12.3	12.8	15.6	15.8	50	100
KFSL-1050	KSIL-1050	KSMT-1016	1/2"	15.8	16.2	19.5	19.9	65	100
KFSL-1075	KSIL-1075	KSMT-1020	3/4"	20.8	21.3	24.7	25.2	75	100
KFSL-1100	KSIL-1100	KSMT-1025	1"	26.4	27.1	31.6	32.1	100	100
KFSL-1125	KSIL-1125	KSMT-1032	1-1/4"	35.0	35.5	40.0	40.5	125	50
KFSL-1150	KSIL-1150	KSMT-1038	1-1/2"	40.1	40.6	45.8	46.3	150	50
KFSL-1200	KSIL-1200	KSMT-1050	2"	50.5	51.2	57.3	58.0	175	30
KFSL-1250	KSIL-1250		2-1/2"	62.9	63.9	72.1	73.1	200	30
KFSL-1300	KSIL-1300		3"	77.0	78.0	87.0	88.0	225	30
KFSL-1400	KSIL-1400		4"	99.6	101.6	108.7	110.5	275	30
KFSL-1400			5"	125.0	127.0	135.0	137.0	300	15
KFSL-1600			6"	150.0	153.0	160.0	162.5	400	15

SQUARE-LOCKED

INTERLOCKED
Note:-

- All standard measurements are in United States inches unless otherwise specified.
- Metric size ID & OD will change accordingly if required please consult.
- For Aluminium - Please add KFSL-1025-AL
- For Stainless Steel - 304 grade please add 34 to KFSL 34-1025
- 316 grade please add 36 to KFSL 36-1025



PVC Coated Steel Flexible Conduit (KF-1707)

This PVC jacketed flexible metallic conduit is suitable for use in both static applications where a tight bend diameter is needed and in dynamic use such as machining centers and robotics.

Flexible Steel Reinforced PVC Coated Conduit

Vacuum jacketed flexible steel conduit for high-flex installations
Also widely used for lighting fixtures cables protection.

- Galvanized steel strip core (square locked or interlocked)
- PVC Covered
- Trade size 1/4" to 6" - 16mm to 50mm
- **Available in cut length fixed with connectors as per the clients request.**
- **Over all steel braid please look into KF-1704 series.**

Flexible PVC Covering
(Vacuum Jacketed With
Corrugated Surface)



Galvanized Steel Strip
Helically Wound
(Square Locked Or
Interlocked Construction)

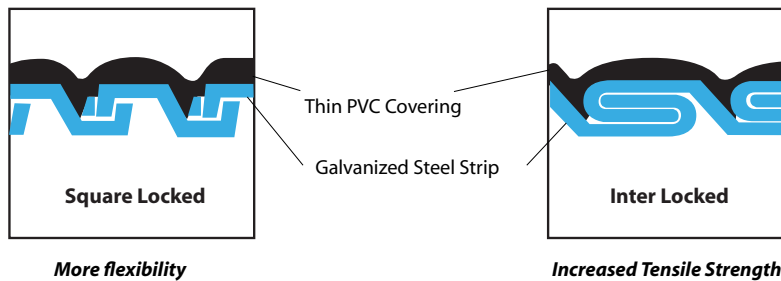

PVC covered flexible metal conduit is suitable for use in both static applications where a tight bend diameter is needed and in dynamic use such as machining centers and robotics. Most suitable for use with conduit fittings covering a broad range of electrical wiring applications.

A unique vacuum extrusion process allows this flexible metal conduit to have a thin PVC jacket which does not restrict the great flexibility characteristics of the inner core.

Flexible metallic conduit with PVC jacket:

- PVC jacket (VJC) provides weather proof - IP55 (when used with IP-65 connection).
- Durable and long life.
- Inner core made from galvanized steel strip.
- Square locked construction for more flexibility or interlocked for more strength.
- Temperature -40° to 90° C.

Features & Applications:

- Appliances, automotive wire & cable sleeving, industrial equipments.
- Medical devices, machineries, general wire conduits, air conditioning/heating and ventilation.
- Hot dipped galvanized for superior protection inside & outside.
- Smooth Inner finish for every wiring installation.
- Corrosion resistant.
- Available in cut length fixed with both sides connector as per the clients request..

Square Locked	Inter Locked	Metric Thread	Trade Size	I.D. (mm)		O.D. (mm)		Min. Bending Radius (mm)	Feet / Coil
				Min.	Max.	Min.	Max.		
KFSLP-1025	KSILP-1025		1/4"	9.7	10.2	14.4	14.7	45	100
KFSLP-1030	KSILP-1030		3/8"	12.3	12.8	16.4	16.8	50	100
KFSLP-1050	KSILP-1050	KSMT-1016	1/2"	15.8	16.2	20.3	20.7	65	100
KFSLP-1075	KSILP-1075	KSMT-1020	3/4"	20.8	21.3	25.6	26.9	75	100
KFSLP-1100	KSILP-1100	KSMT-1025	1"	26.4	27.1	32.6	33.1	100	100
KFSLP-1125	KSILP-1125	KSMT-1032	1-1/4"	35.0	35.5	41.2	41.7	125	50
KFSLP-1150	KSILP-1150	KSMT-1038	1-1/2"	40.1	40.6	47.2	47.8	150	50
KFSLP-1200	KSILP-1200	KSMT-1050	2"	50.5	51.2	58.7	59.4	175	30
KFSLP-1250	KSILP-1250		2-1/2"	62.9	63.9	74.1	75.1	200	30
KFSLP-1300	KSILP-1300		3"	77.0	78.0	89.0	90.0	225	30
KFSLP-1400	KSILP-1400		4"	99.6	101.6	111.2	112.4	275	30
KFSLP-1400			5"	122.0	128.0	132.0	138.0	300	15
KFSLP-1600			6"	147.0	153.0	157.0	163.0	400	15

SQUARE-LOCKED

INTERLOCKED
Note:-

- All standard measurements are in United States inches unless otherwise specified.
- Metric size ID & OD will change accordingly if required please consult.
- For Aluminium - Please add KFSLP-1025-AL
- For Stainless Steel - 304 grade please add 34 to KFSLP 34-1025
- 316 grade please add 36 to KFSLP 36-1025



Screw-in Fitting For Flexible Metallic Conduits
Model: SCREW-IN CONNECTOR

Category: Flexible Metal Conduit Fittings

Description: Connector, Screw-In, Zinc Die Cast

Application: Used to connect flexible metal conduit to box or enclosure.

Material: Zinc Die Cast

Trade Size: 3/8", 1/2", 3/4", 1"

**Screw in Connector
KFSC**

Size	1/4"	3/8"	1/2"	3/4"	1"
Part No.	KFSC-1025	KFSC-1030	KFSC-1050	KFSC-1075	KFSC-1100

Model: SCREW-IN COUPLER

SCREW-IN COUPLER Category: Flexible Metal Conduit

Description: Coupling, Screw-In, Zinc Die Cast

Application: Used to join two lengths of flexible metal conduit.

Material: Zinc Die Cast

Trade Size: 3/8", 1/2", 3/4", 1", 1-1/4", 1-1/2", 2"

**Screw in Coupler
KFSCC**

Size	1/4"	3/8"	1/2"	3/4"	1"
Part No.	KFSCC-1025	KFSCC-1030	KFSCC-1050	KFSCC-1075	KFSCC-1100

Metric Adaptor

**Light Duty
KLTC**

**IP65
KLTCs**

Size	16mm	20mm	25mm	32mm	38mm	50mm
Part No.	KLTC-1016	KLTC-1020	KLTC-1025	KLTC-1032	KLTC-1038	KLTC-1050
Part No.	KLTCs-1016	KLTCs-1020	KLTCs-1025	KLTCs-1032	KLTCs-1038	KLTCs-1050



Squeeze Type BX-Flex Connector (US style)

Material: Zinc Die Cast, most suitable for use with flexible metal conduit
 Used to connect flexible metal conduit or armored cable to box or enclosure.

Squeeze Connector

Size	1/4"	3/8"	1/2"	3/4"	1"	1-1/4"	1-1/2"	2"	2-1/2"	3"	4"
Zinc Die Cast (ZD)	KFC-1025	KFC-1030	KFC-1050	KFC-1075	KFC-1100	KFC-1125	KFC-1150	KFC-1200	KFC-1250	KFC-1300	KFC-1400
ZD Insulated	KFCI-1025	KFCI-1030	KFCI-1050	KFCI-1075	KFCI-1100	KFCI-1125	KFCI-1150	KFCI-1200	KFCI-1250	KFCI-1300	KFCI-1400
ZD 90°	KFC90-1025	KFC90-1030	KFC90-1050	KFC90-1075	KFC90-1100	KFC90-1125	KFC90-1150	KFC90-1200	KFC90-1250	KFC90-1300	KFC90-1400
ZD 90° Insulated	KFCI90-1025	KFCI90-1030	KFCI90-1050	KFCI90-1075	KFCI90-1100	KFCI90-1125	KFCI90-1150	KFCI90-1200	KFCI90-1250	KFCI90-1300	KFCI90-1400
ZD 45°	KFC45-1025	KFC45-1030	KFC45-1050	KFC45-1075	KFC45-1100	KFC45-1125	KFC45-1150	KFC45-1200	KFC45-1250	KFC45-1300	KFC45-1400
ZD45° Insulated	KFCI45-1025	KFCI45-1030	KFCI45-1050	KFCI45-1075	KFCI45-1100	KFCI45-1125	KFCI45-1150	KFCI45-1200	KFCI45-1250	KFCI45-1300	KFCI45-1400
Melleable Iron (MI)	KFCS-1025	KFCS-1030	KFCS-1050	KFCS-1075	KFCS-1100	KFCS-1125	KFCS-1150	KFCS-1200	KFCS-1250	KFCS-1300	KFCS-1400
MI Insulated	KFCSI-1025	KFCSI-1030	KFCSI-1050	KFCSI-1075	KFCSI-1100	KFCSI-1125	KFCSI-1150	KFCSI-1200	KFCSI-1250	KFCSI-1300	KFCSI-1400
MI 90°	KFCS90-1025	KFCS90-1030	KFCS90-1050	KFCS90-1075	KFCS90-1100	KFCS90-1125	KFCS90-1150	KFCS90-1200	KFCS90-1250	KFCS90-1300	KFCS90-1400
MI 90° Insulated	KFCSI90-1025	KFCSI90-1030	KFCSI90-1050	KFCSI90-1075	KFCSI90-1100	KFCSI90-1125	KFCSI90-1150	KFC-1200	KFCSI90-1250	KFCSI90-1300	KFCSI90-1400
MI 45°	KFCS45-1025	KFCS45-1030	KFCS45-1050	KFCS45-1075	KFCS45-1100	KFCS45-1125	KFCS45-1150	KFCS45-1200	KFCS45-1250	KFCS45-1300	KFCS45-1400
MI 45° Insulated	KFCSI45-1025	KFCSI45-1030	KFCSI45-1050	KFCSI45-1075	KFCSI45-1100	KFCSI45-1125	KFCSI45-1150	KFCSI45-1200	KFCSI45-1250	KFCSI45-1300	KFCSI45-1400

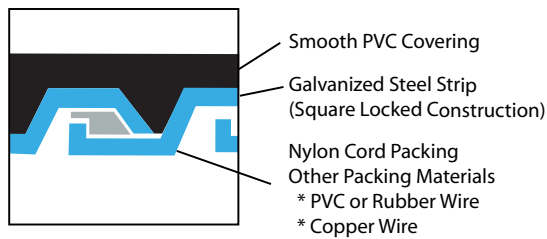

Liquid Tight Flexible Conduit (KF-1702)

**Complies with
UL-360
EN 61386-25:2011**

Nylon / Rubber Sealing Cord
(For increased strength & moisture protection)

- Features**
- Liquid-tight
 - High tensile strength
 - Good Mechanical Protection
 - Temperature -60° to 90°C

Kruppsflex™ KLT gives protection for wiring circuits located in extremely wet or damp areas. Also suitable for machines and equipment where ruggedness is required. Now in use on presses, welders, pumps, blowers, grinders, conveyors, automated lines, etc.

For extreme temperature please look into KF-1706 series
For overall steel braid please look into KF-1705 series

ULC LISTED:

Type	Trade Size	I.D. (mm)		O.D. (mm)		Min. Bending Radius (mm)	Feet / Coil
		Min.	Max.	Min.	Max.		
KLT-1025	1/4"	6.2	6.7	11.4	11.9	35	100
KLT-1030	3/8"	12.3	12.8	18.0	18.3	50	50
KLT-1050	1/2"	15.8	16.2	22.0	22.5	60	50
KLT-1075	3/4"	20.8	21.3	26.5	27.0	75	30
KLT-1100	1"	26.4	27.1	34.0	34.5	100	30
KLT-1125	1-1/4"	35.0	35.5	42.8	43.5	135	20
KLT-1150	1-1/2"	40.1	40.6	48.5	49.0	160	20
KLT-1200	2"	50.5	51.2	61.3	62.0	190	15
KLT-1250	2-1/2"	62.9	63.6	72.1	73.0	300	10
KLT-1300	3"	77.9	78.7	87.8	88.9	450	10
KLT-1400	4"	101.6	102.6	113.2	114.3	600	5

NON ULC LISTED:

5" & 6" large size liquid tight conduits are constructed with a fully interlocked strip for added strength and to prevent unraveling. Resistant to most industrial oils, acids and vapors.



Type	Trade Size	I.D. (mm)		O.D. (mm)		Min. Bending Radius (mm)	Feet / Coil
		Min.	Max.	Min.	Max.		
KLT-1500	5"	122.0	128.0	132.0	138.0	800	5
KLT-1600	6"	147.0	153.0	157.0	163.0	1000	5



FEATURES:

- Galvanized steel core for lasting mechanical protection
- UL Rating: 90°C dry, 60°C wet, 70°C oil resistant
- Resists abuse, pull and crushing
- Resists corrosion, abrasion, oil, water (IP67), acid, metal shavings, and rough environments
- Smooth inside for easier wire pulling, no hazardous sharp edges or burrs, will not damage conductors
- Durable, abrasion resistant PVC jacket won't wrinkle or shrink from cut ends
- Exceptional crush proof qualities
- Smooth interior for easy wire pull-thru
- Complete protection against most liquids and moisture vapor
- The armor is approved as an equipment ground
- Superior protection for circuits located in hostile environments
- Complies with UL standard 360, NEC Article 351
- Flame test rating of FT-4 per CSA, C22.2
- Suitable for use in hazardous locations per NEC Article 500 Class I, Div. 2; Classes II and III
- Copper bond wire in 3/8" - 1 1/4"
- Standard package is done in a box upto size 1" and the other size are shrink wrapped coils.
- Outdoor, sunlight resistant, direct burial CSA rating - 18°C to 75°C

INSTALLATION

This category covers liquid-tight flexible metal conduit in trade sizes 3/8 to 4 (metric designators 12 to 103) inclusive, for installation in accordance with Article 350 of ANSI/NFPA 70, "National Electrical Code" (NEC). Liquid-tight flexible metal conduit is intended for use with conductors in circuits of 600 V nominal or less. This product may also be used for installation of conductors in motor circuits, and for electric signs and outline lighting in accordance with the NEC.

Liquid-tight flexible metal conduit is sunlight resistant and suitable for use outdoors.

Where terminated in fittings investigated for grounding and where installed with not more than 6 ft (total length) in any ground-return path, liquid-tight flexible metal conduit in the 3/8 and 1/2 (12 and 16) trade sizes is suitable for grounding where used on circuits rated 20 A or less, and the 3/4, 1 and 1-1/4 (21, 27 and 35) trade sizes are suitable for grounding where used on circuits rated 60 A or less.

The following are not considered to be suitable as a grounding means:

1. The 1-1/2 (41) and larger trade sizes.
2. The 3/8 and 1/2 (12 and 16) trade sizes where used on circuits rated higher than 20 A, or where the total length in the ground-return path is greater than 6 ft.
3. The 3/4, 1 and 1-1/4 (21, 27 and 35) trade sizes where used on circuits rated higher than 60 A, or where the total length in the ground-return path is greater than 6 ft.

Note:-

- All standard measurements are in united stats inches
- BS Metallic Sizes - please remove 1025 and use 16 for for 16mm & 20 for 20mm
- Metric size at available from 16, 20, 25, 32, 38 & 50mm only)
- Metric size the ID & OD will change accordingly
- For Aluminium - Please add at to KLT-1025-AL
- For Stainless Steel - 304 grade please add 34 to KLT-34-1025
- 316 grade please add 36 to KLT-36-1025

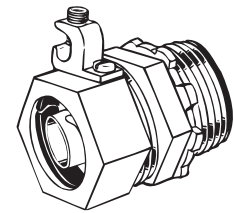
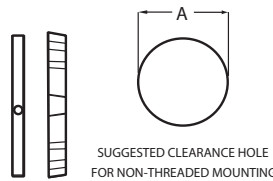
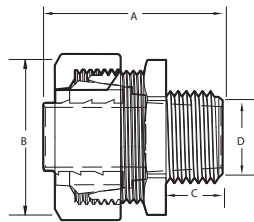
LIQUID TIGHT STRAIGHT CONNECTOR

Grounding

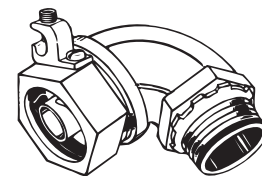
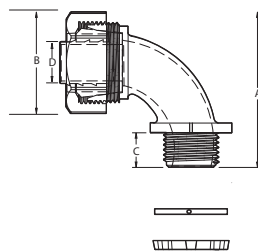
Zinc Die Cast Insulated	Steel	Steel Insulated	Metric Thread	Trade Size	Dimension (mm)			
					A	B	C	D
KLTC-1025	KLTS-1025	KLTSI-1025		1/4"	32	34.5	11.5	9.5
KLTC-1030	KLTS-1030	KLTSI-1030		3/8"	32	34.5	11.5	10.5
KLTC-1050	KLTS-1050	KLTSI-1050	KLTM-1016	1/2"	32.5	34.5	12	13.8
KLTC-1075	KLTS-1075	KLTSI-1075	KLTM-1020	3/4"	34	41	12.5	18
KLTC-1100	KLTS-1100	KLTSI-1100	KLTM-1025	1"	42.5	47	15	24
KLTC-1125	KLTS-1125	KLTSI-1125	KLTM-1032	1-1/4"	49	59	17.5	32.5
KLTC-1150	KLTS-1150	KLTSI-1150	KLTM-1038	1-1/2"	49	65.5	17.5	37
KLTC-1200	KLTS-1200	KLTSI-1200	KLTM-1050	2"	51	78	17.5	48.5
KLTC-1250	KLTS-1250	KLTSI-1250		2-1/2"	74	97	25	59.5
KLTC-1300	KLTS-1400	KLTSI-1300		3"	81	115	25	74
KLTC-1400	KLTS-1400	KLTSI-1400		4"	89	139	29	97
KLTC-1500	KLTS-1500	KLTSI-1500		5"	Information available at the time of order			
KLTC-1600	KLTS-1600	KLTSI-1600		6"				



Grounding
90 DEG CONNECTOR

Zinc Die Cast Insulated	Steel	Steel Insulated	Metric Thread	Trade Size	Dimension (mm)			
					A	B	C	D
KLTC90-1025	KLTS90-1025	KLTSI90-1025		3/8"	20.9	30.0	11.0	54.0
KLTC90-1050	KLTS90-1050	KLTSI90-1050	KLTM90-1016	1/2"	20.9	35.5	11.0	57.0
KLTC90-1075	KLTS90-1075	KLTSI90-1075	KLTM90-1020	3/4"	26.4	43.0	14.0	67.0
KLTC90-1100	KLTS90-1100	KLTSI90-1100	KLTM90-1025	1"	33.1	48.0	15.0	73.0
KLTC90-1125	KLTS90-1125	KLTSI90-1125	KLTM90-1132	1-1/4"	41.9	58.0	15.0	93.5
KLTC90-1150	KLTS90-1150	KLTSI90-1150	KLTM90-1138	1-1/2"	47.5	64.2	16.0	103.0
KLTC90-1200	KLTS90-1200	KLTSI90-1200	KLTM90-1150	2"	59.0	86.6	18.0	126.0
KLTC90-1250	KLTS90-1250	KLTSI90-1250		2-1/2"	75.4	103.0	22.0	165.0
KLTC90-1300	KLTS90-1400	KLTSI90-1300		3"	87.5	120.0	22.0	189.0
KLTC90-1400	KLTS90-1400	KLTSI90-1400		4"	113.0	157.0	24.0	229.0
KLTC90-1500	KLTS90-1500	KLTSI90-1500		5"	136.0	175.0	30.0	280.0
KLTC90-1600	KLTS90-1600	KLTSI90-1600		6"	162.0	200.0	40.0	320.0

Zinc Die Cast Insulated	Steel	Steel Insulated	Metric Thread	Trade Size	Dimension (mm)			
					A	B	C	D
KLT45-1025	KLTS45-1025	KLTSI45-1025		3/8"	20.9	30.0	11.0	54.0
KLT45-1050	KLTS45-1050	KLTSI45-1050	KLTM45-1016	1/2"	20.9	35.5	11.0	57.0
KLT45-1075	KLTS45-1075	KLTSI45-1075	KLTM45-1020	3/4"	26.4	43.0	14.0	67.0
KLT45-1100	KLTS45-1100	KLTSI45-1100	KLTM45-1025	1"	33.1	48.0	15.0	73.0
KLT45-1125	KLTS45-1125	KLTSI45-1125	KLTM45-1032	1-1/4"	41.9	58.0	15.0	93.5
KLT45-1150	KLTS45-1150	KLTSI45-1150	KLTM45-1038	1-1/2"	47.5	64.2	16.0	103.0
KLT45-1200	KLTS45-1200	KLTSI45-1200	KLTM45-1050	2"	59.0	86.6	18.0	126.0
KLT45-1250	KLTS45-1250	KLTSI45-1250		2-1/2"	75.4	103.0	22.0	165.0
KLT45-1300	KLTS45-1400	KLTSI45-1300		3"	87.5	120.0	22.0	189.0
KLT45-1500	KLTS45-1500	KLTSI45-1400		4"	113.0	157.0	24.0	229.0
KLT45-1500	KLTS45-1500	KLTSI45-1500		5"	136.0	175.0	30.0	280.0
KLT45-1600	KLTS45-1600	KLTSI45-1600		6"	162.0	200.0	40.0	320.0

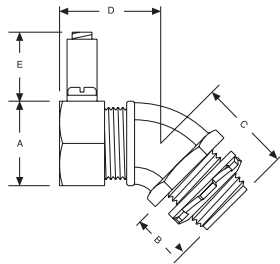

45° Connector



A = Nut Flats
 B = Thread length and thread spec.
 C = Thread to bend
 D = Nut to bend
 E = Lug height

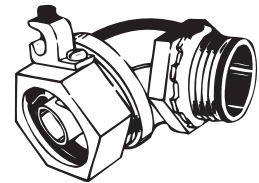

Grounding

For grounding please add G along with Part No. for 1/2" straight connection with grounding part no. KLTCG-1025

- Suitable for outside, inside, and industrial uses including transformer connections, airconditioning, and heating.
- Suitable for use in both wet and dry location.
- Provides smooth connection, no sharp edges to strip wire.
- Cost effective die-cast zinc construction provides durability and resists rough environments.
- Supplied with locknut and plastic sealing ring.
- Fits the most common sizes of nonmetallic liquid tight conduit.
- For use with Kruppsflex™ Liquid Tight Conduit.
- For metallic thread please add KLTC-16 for 16mm adaptor.
- For metallic thread the adaptor are brass nickle plated.
- Metallic thread is available only from 16 to 50 mm.
- Metallic thread adaptor are with lock ring as standard.

Material	Die cast zinc, Galvanized Steel
Ingress Protection	Liquid tight when used with Kruppsflex™ electrical conduit

Note:-

- All standard measurements are in united stats inches
- Metric size the ID & OD will change accordingly
- For Aluminium - Please add at to KLTC- 1025-AL
- For Stainless Steel - 304 grade please add 34 to KLTC 34-1025
- 316 grade please add 36 to KLTC 36-1025
- For PVC Coated: Please add PVC to KLTC- 1025-PVC

Combination Coupling For Steel Flexible Conduit
Connection flexible connecting flexible conduct to EMT/4 PVC Tubes

Material: Zinc Die Cast or Steel liquidtight connector

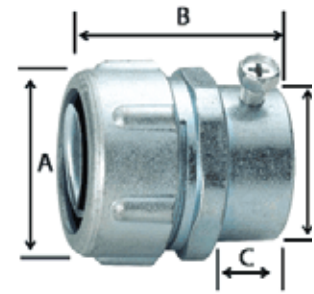
Set Screw Connector Coupling

Steel	Zinc Die Cast	Trade Size	Dimension (mm)				
			I.D.	A	B	C	D
KLTSCC-1025	KLTC-1025	3/8"	11.2	28.3	44.6	13.2	16.4
KLTSCC-1030	KLTC-1030	1/2"	14.8	34.2	44.6	13.2	9.6
KLTSCC-1075	KLTC-1075	3/4"	18.7	41.1	51.0	14.3	25.9
KLTSCC-1100	KLTC-1100	1"	24.8	48.6	58.1	19.2	32.3
KLTSCC-1125	KLTC-1125	1-1/4"	33.1	56.6	70.2	20.8	38.6
KLTSCC-1150	KLTC-1150	1-1/2"	38	71.3	75.7	21.7	51.3
KLTSCC-1200	KLTC-1200	2"	48.8	86.6	84.4	21.7	64.0
KLTSCC-1250	KLTC-1250	2-1/2"	59.4	103.1	101.8	25.9	76.8
KLTSCC-1300	KLTC-1300	3"	75.8	120.0	110.0	26.4	89.8
KLTSCC-1400	KLTC-1400	4"	97.6	157.0	118.6	30.5	115.0

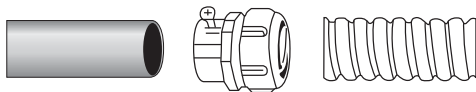

Typical applications for liquidtight combination connector with Set Screw:
Coupling a flexible conduit to EMT or PVC conduit

Combination Coupling for Steel flexible conduit with female thread
Used to join either metallic or non-metallic (Type "B") liquid tight conduit to external threads.

Material: Zinc Die Cast or Steel, Zinc or Chrome Plated

- Available in 3/8 inch to 4 inches trade sizes
- Resistant to outdoor weather conditions
- Liquidtight/Raintight/Oiltight, Suitable for wet locations
- Straight & Elbow

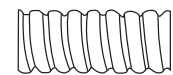
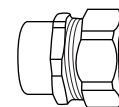
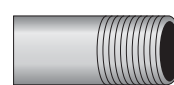
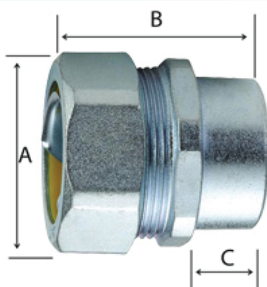

Typical applications for liquidtight connector with internal threads:
Coupling a flexible conduit to IMC or RSC conduit

Steel	Zinc Die Cast	90°		45°		Trade Size	Dimension (mm)				
		Zinc	Steel	Zinc	Steel		I.D.	A	B	C	Thread
KLTSFC-1025	KLTF-1025	KLTF90-1025	KLTF90-1025	KLTF90-1025	KLTF90-1025	3/8"	11.2	28.3	44.6	13.2	PT 1/2"
KLTSFC-1030	KLTF-1030	KLTF90-1025	KLTF90-1025	KLTF90-1025	KLTF90-1025	1/2"	14.8	34.2	44.6	13.2	PT 1/2"
KLTSFC-1075	KLTF-1075	KLTF90-1025	KLTF90-1025	KLTF90-1025	KLTF90-1025	3/4"	18.7	41.1	51.0	14.3	PT 3/4"
KLTSFC-1100	KLTF-1100	KLTF90-1025	KLTF90-1025	KLTF90-1025	KLTF90-1025	1"	24.8	48.6	58.1	19.2	PT 1"
KLTSFC-1125	KLTF-1125	KLTF90-1025	KLTF90-1025	KLTF90-1025	KLTF90-1025	1-1/4"	33.1	56.6	70.2	20.8	PT 1-1/4"
KLTSFC-1150	KLTF-1150	KLTF90-1025	KLTF90-1025	KLTF90-1025	KLTF90-1025	1-1/2"	38	71.3	75.7	21.7	PT 1-1/2"
KLTSFC-1200	KLTF-1200	KLTF90-1025	KLTF90-1025	KLTF90-1025	KLTF90-1025	2"	48.8	86.6	84.4	21.7	PT 2"
KLTSFC-1250	KLTF-1250	KLTF90-1025	KLTF90-1025	KLTF90-1025	KLTF90-1025	2-1/2"	59.4	103.1	101.8	25.9	PT 2-1/2"
KLTSFC-1300	KLTF-1300	KLTF90-1025	KLTF90-1025	KLTF90-1025	KLTF90-1025	3"	75.8	120.0	110.0	26.4	PT 3"
KLTSFC-1400	KLTF-1400	KLTF90-1025	KLTF90-1025	KLTF90-1025	KLTF90-1025	4"	97.6	157.0	118.6	30.5	PT 4"

Flexible Steel Conduit Over all Braided (**KF1701**)

Over all Braided Steel Flexible Conduit typically used for machinery to protect cables and wirings devices.

As part of the Braided system range, this braided flexible metal conduit has **inherent fire protection, high pull off strength** and offers **EMI screening**.

- Galvanized steel helically wound with metal wire over-braiding
- Trade size 3/8" to 6" & Metric size from 16mm to 50mm
- EMI/RFI shielding
- For heavy mechanical stress
- High fatigue life
- Resists high temperature and hot metal splashes -40° to 105°C.
- All metallic constructions
- Steel Braiding SS304 grade.
- **Available in cut length fixed with connectors as per the clients request.**

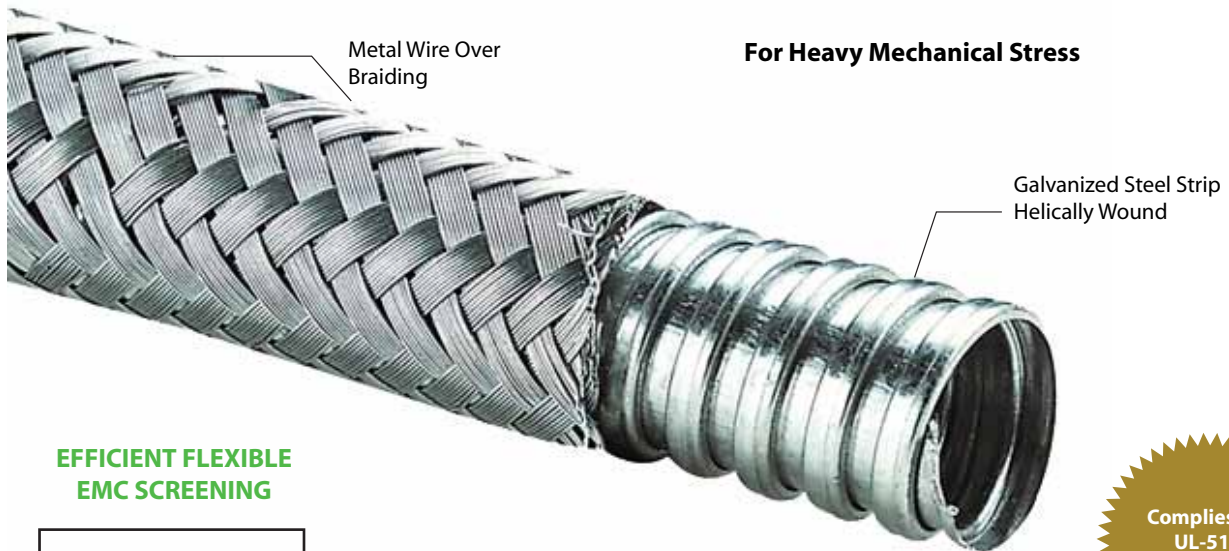

EFFICIENT FLEXIBLE EMC SCREENING

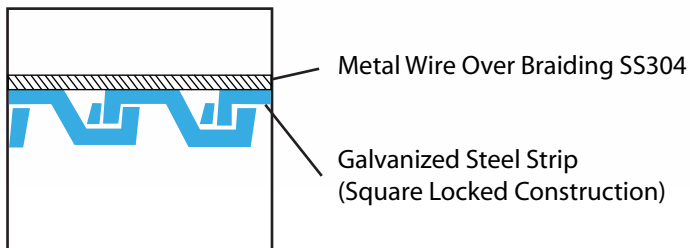

Complies with
UL-514B
EN 61386-25:2011

Features

- EMI Shielding
- Resists hot metal splashes
- Very flexible
- Temperature -40 to 105°C
- SS304 grade overall Braid

FLEXIBLE STEEL CONDUIT WITH OVER ALL BRAID:

- Wire over-braiding provide more abrasion resistant and EMI/RFI shielding (EMI screening).
- Durable and long life.
- Inner core made from galvanized steel strip.
- Low fire hazard
- Resists hot metal splashes and high temperature -40 to 105°C
- Overbraided conduits are particularly suitable for installation in vibration environments.

GALVANISED STEEL CONDUIT WITH STEEL OVERBRAIDING, This conduit utilises strip wound steel conduit as a core, which is then over-braided with steel. The wire over braid provides abrasion resistance and protects the core from mechanical damage. Braided steel conduits provide high mechanical strength yet offer high flexibility. The conduit, at full extension, offers high tensile strength without elongation thus protecting cables from being over-tensioned or stretched. It will provide an enhanced level of EMI screening and a wide operating temperature. Resists hot swarfs.

Braided Flexible Metal Conduit is widely used to counter mechanical stress and is highly flexible, and it is resistant against tensile stresses and transverse pressure. This conduit also offers excellent protection to cables against hot metal particles, and immunity from electromagnetic interference.

Applications:

Most suitable for use in industrial environments and high temperatures, such as wiring welding machines and metal casting machines; Also for demanding industrial environments where higher abrasion resistance or EMI screening are required.

Type	Trade Size	I.D. (mm)		O.D. (mm)		Min. Bending Radius (mm)	Feet / Coil
		Min.	Max.	Min.	Max.		
KFS-1010	-	7.5	8.3	10.8	11.6	35	100
KFS-1025	1/4"	9.7	10.2	14.5	15.0	40	100
KFS-1030	3/8"	12.3	12.8	16.6	16.8	50	50
KFS-1050	1/2"	15.8	16.2	20.5	20.9	65	50
KFS-1075	3/4"	20.8	21.3	25.7	26.2	75	50
KFS-1100	1"	26.4	27.1	32.6	33.1	100	50
KFS-1125	1-1/4"	35.0	35.5	41.0	41.5	125	30
KFS-1150	1-1/2"	40.1	40.6	46.8	47.3	150	30
KFS-1200	2"	50.5	51.2	58.3	59.0	175	20
KSF-1250	2-1/2"	62.9	63.9	73.1	74.1	200	10
KFS-1300	3"	77.0	78.0	88.0	89.0	225	10
KFS-1400	4"	99.6	101.6	109.7	111.5	275	10
KFS-1500	5"	125.0	127.0	137.0	139.0	350	5
KFS-1600	6"	150.0	153.0	162.0	164.5	480	5

Note:-

- All standard measurements are in united stats inches
- BS Metallic Sizes - please remove 1025 and use 16 for for 16mm & 20 for 20mm
- Metric size at available from 16, 20, 25, 32, 38 & 50mm only)
- Metric size the ID & OD will change accordingly
- For Aluminium - Please add at to KFS-1025-AL
- For Stainless Steel - 304 grade please add 34 to KFS 34-1025
- 316 grade please add 36 to KFS 36-1025

PVC Coated Flexible Steel Conduit Over All Braided (KF-1704)

Typically used for steel mills machineries, robotics and petrochemical industrial cable protection

- Galvanized steel helically wound, square locked type construction braided metallic conduit with PVC coating and wire over-braid. Metal braiding provides increased abrasion resistance.
- Weather-tight-IP55
- EMI/RFI shielding
- Resists hot metal splashes -40° to 105°C
- Steel Braiding SS304 grade



Steel Over All Braid (SS304)

Galvanized Steel Strip Helically Wound

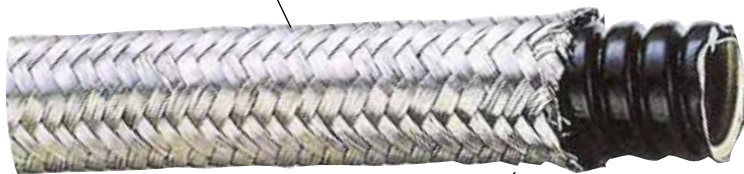

Flexible PVC Covering (With Corrugated Surface)

EFFICIENT FLEXIBLE EMC SCREENING



PACKED

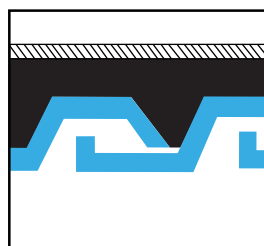

Steel Over all Braiding (SS304)
PVC Covering (Corrugated Surface)
Galvanized Steel Strip (Square Locked Construction)

Complies with
UL-514B
EN 61386-25:2011

- 1) Electromagnetic Interference (EMI) considerations, EMC screening:
Computer rooms, telecommunications, control systems, PLC circuit
- 2) Abrasion resistance considerations:
Railway rolling stock, heavy duty industrial applications
- 3) Hot metal splashes resistance considerations:
Steel mills, petrochemical plants, Heavy Industrial wirings
- 4) Mechanical integrity:
Security/CCTV, anti-vandal applications, robotics, Ships & Trains

Features

- PVC Coated
- Very Flexible
- EMI/RFI Shielding
- Abrasion
- Hot Metal Resistant
- Temperature -40 to 105°C
- SS304 grade overall Braid

Conduit With Pvc Coated Over All Braid:

- Wire over-braiding provides more abrasion resistance and efficient EMI/RFI shielding.
- Durable and long life.
- Inner core made from galvanized steel strip.
- Square locked construction for more dynamic flexibility.
- Resists hot metal splashes and high temperature -40 to 105°C
- PVC covering provides moisture protections for the electrical conductors
- Braided flexible conduit assembly

Applications:

Suitable for Industrial environments where higher abrasion resistance or screening and water tightness are required. Most suitable for petrochemical and steel mills electric wirings management.

Type	Trade Size	I.D. (mm)		O.D. (mm)		Min. Bending Radius (mm)	Feet / Coil
		Min.	Max.	Min.	Max.		
KFP-1025	1/4"	9.7	10.2	15.4	15.7	60	100
KFP-1030	3/8"	12.3	12.8	17.4	17.8	70	100
KFP-1050	1/2"	15.8	16.2	21.3	21.7	90	50
KFP-1075	3/4"	20.8	21.3	26.6	27.0	110	50
KFP-1100	1"	26.4	27.1	33.6	34.1	150	50
KFP-1125	1-1/4"	35.0	35.5	42.2	42.7	175	30
KFP-1150	1-1/2"	40.1	40.6	48.2	48.8	200	25
KFP-1200	2"	50.5	51.2	58.7	59.4	230	20
KFP-1250	2-1/2"	62.9	63.9	75.1	76.1	250	10
KFP-1300	3"	77.0	78.0	90.0	91.0	300	10
KFP-1400	4"	99.6	101.6	112.2	113.4	500	10

Note:-

- All standard measurements are in United States inches unless otherwise specified.
- For Metric Sizes please add 116 for 16mm flexible conduit (for Ex: KFSH-1116 instead of 1050)
- Metric sizes are available from 16, 20, 25, 32, 38 & 50mm only)
- Metric size ID & OD will change accordingly if required please consult.
- For Aluminium - Please add KFP-1025-AL
- For Stainless Steel - 304 grade please add 34 to KFP 34-1025
- 316 grade please add 36 to KFP 36-1025



Liquid Tight Flexible Conduit with Steel Braid (KF-1705)

Galvanised flexible Steel Conduit, Smooth PVC Covering, Metal Overbraid

Type KF-1705 is a stainless steel (SS304) braided version of Liquidtight Metallic Conduit. It is mainly used in extreme environments (with massive mechanical strength). Braided liquidtight conduit is used for applications requiring a high degree of mechanical strength and flexibility. It is suitable for outdoor use and is used for exposed wiring underneath railway rolling stock. It also provides EMI screening for data cables.

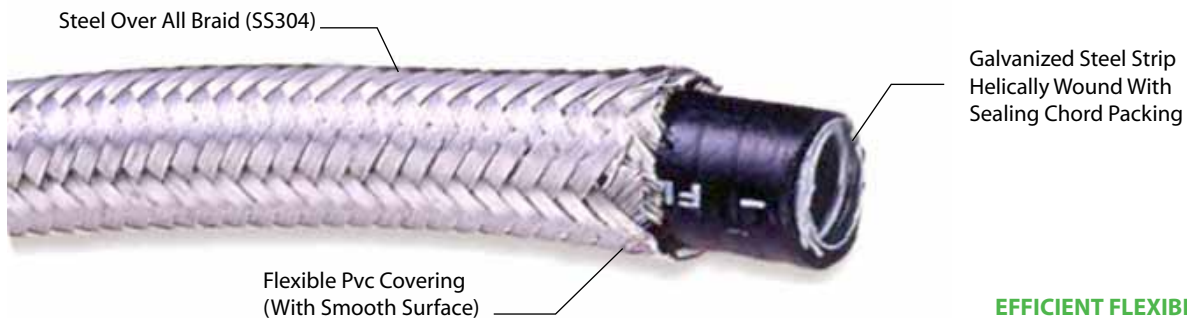

**EFFICIENT FLEXIBLE
EMC SCREENING**

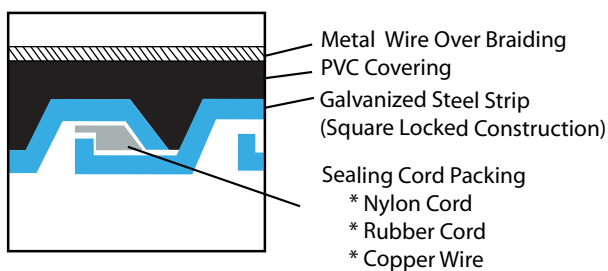

Liquidtight Flexible Shielding Conduit most suitable for demanding industrial wiring applications.

- Galvanized steel helically wound with PVC covering and wire over-braid.
- Trade size: 3/8"~4" (square locked, with Nylon cord packing.), Other packing materials, such as rubber wire, or copper wire is also available.
- Liquid-tight (Water Resistant IP67)
- EMI/RFI shielding
- Explosion proof (Suitable for use in Hazardous Location)
- High tensile strength
- Resists hot metal splashes (-40 to 105 °C)

**Complies with
UL-360
EN 61386-25:2011**

Features

- Liquid-tight (Water Resistant IP67)
- EMI/RFI Shielding
- Abrasion Resistant
- Explosion proof (Zone 1 Div II)
- Temperature -40 to 105 °C

EMI/RFI Shielding Liquid-Tight Metal Conduit: This conduit is designed to **protect sensitive electronic circuits wirings** in applications such as industry automation, airport communications, radar and data transmission from Electro-Magnetic and Radio Frequency Interference (EMI / RFI). Most suitable for radar equipments, airports, CNC machineries and PLC wirings in industrial environments.

KF-1705 LIQUIDTIGHT CONDUIT:

- Wire over-braiding provides more abrasion resistant, EMI/RFI shielding and resistance to hot metal splashes.
- Explosion proof (Class I, Div. 2 and Classes II and Div II) when used with KF-1706 series flexible conduit.
- Liquid-tight durable and long life (Water Resistant IP67).
- High tensile strength.
- Inner core made from galvanized steel strip.
- Square locked construction with packing for more tensile strength and moisture tightness, (IP67 PROTECTION)
- Other packing materials: copper bonding (grounding) wire, PVC wire packing is also available.
- **Available in cut length fixed with connectors as per the clients request.**

Applications:

Suitable for use in Hazardous Locations when used with KF-1706 series flexible conduit Industrial environments where higher abrasion resistance or screening are required. It is designed to protect sensitive electronic circuits in applications such as communications, radar and data transmission. Over Braided Metal Liquid Tight Conduit is most suitable for protecting vulnerable industrial cables.

Type	Trade Size	I.D. (mm)		O.D. (mm)		Min. Bending Radius (mm)	Feet / Coil
		Min.	Max.	Min.	Max.		
KFT-1025	1/4"	6.2	6.7	11.4	11.9	35	100
KFT-1030	3/8"	12.3	12.8	18.0	18.3	50	100
KFT-1050	1/2"	15.8	16.2	22.0	22.5	60	100
KFT-1075	3/4"	20.8	21.3	26.5	27.0	75	100
KFT-1100	1"	26.4	27.1	34.0	34.5	100	100
KFT-1125	1-1/4"	35.0	35.5	42.8	43.5	135	50
KFT-1150	1-1/2"	40.1	40.6	48.5	49.0	160	50
KFT-1200	2"	50.5	51.2	61.3	62.0	190	50
KFT-1250	2-1/2"	62.9	63.6	72.1	73.0	300	50
KFT-1300	3"	77.9	78.7	87.8	88.9	450	15
KFT-1400	4"	101.6	102.6	113.2	114.3	600	15

Note:-

- All standard measurements are in United States inches unless otherwise specified.
- Metric size ID & OD will change accordingly if required please consult.
- For Aluminium - Please add KFT-1025-AL
- For Stainless Steel - 304 grade please add 34 to KFT 34-1025
- 316 grade please add 36 to KFT 36-1025



Liquid Tight Thermoplastic Rubber Covered Conduit (Extreme Temperature) (KF-1706)

Type KF-1706 Thermoplastic Rubber Covered Steel Liquid Tight Conduit is well suited for exposure to extreme climatic conditions. It is also widely used on industrial process equipment such as Annealing Ovens, Lumber Kilns, Foundries, Refrigeration, etc. It is a conduit designed to withstand an extreme temperature range. Used in situations where concerns of resistance to temperature exposure exist. This includes heavy outdoor equipment, boilers, furnaces and sub-zero areas.

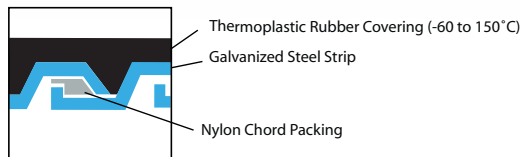
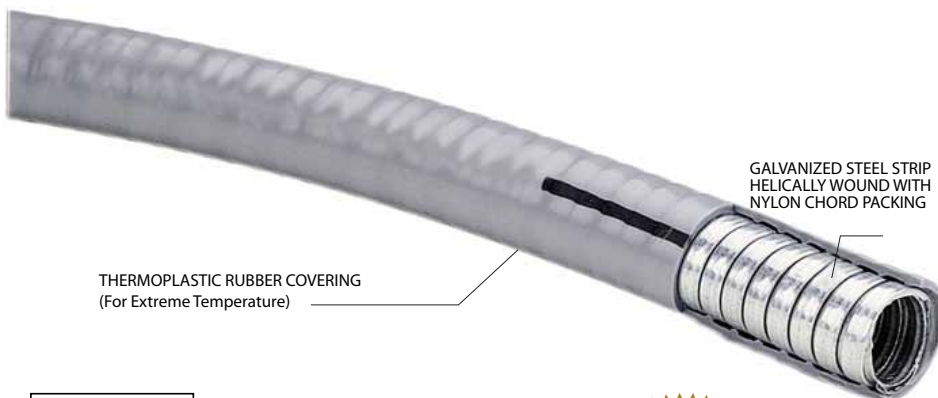

Complies with
UL-360
EN 61386-25:2011

Features

- Liquid-tight
- High tensile strength
- Good Mechanical Protection
- Temperature -60 to 150°C

- Durable and long life.
- High tensile strength.
- Inner core made from a spiral wound strip of corrosion resistant galvanized steel.
- Square locked construction with packing for more strength and smooth wipe clean RUBBER covering surface.
- Liquid tight. Complete protection against most liquids and moisture vapor. Resistance to extreme temperature exposure (Hi-Lo Temperature -60 to 150°C).

Thermoplastic Rubber Covered Liquidtight flexible metal conduit is manufactured from an electro-galvanised steel flexible inner core which is pressure coated with an oil resistant, high temperature grade of Thermoplastic Rubber. The Rubber is keyed into the corrugations of the inner steel flexible core, preventing the rubber covering from wrinkling when the conduit is bent to its minimum bending radius.

Applications:

Used in situations where concerns of resistance to extreme temperature exposure exist. These include heavy outdoor equipment, boilers, furnaces and sub-zero areas.

Liquid Tight Conduits are now in extensive use on presses, welders, pumps, blowers, grinders, conveyors, machines and portable tools, automated lines, and in construction, power plants, industry, commerce and transportation.

Type	Trade Size	I.D. (mm)		O.D. (mm)		Min. Bending Radius (mm)	Feet / Coil
		Min.	Max.	Min.	Max.		
KFR-1025	1/4"	6.2	6.7	11.4	11.9	35	100
KFR-1030	3/8"	12.3	12.8	18.0	18.3	50	50
KFR-1050	1/2"	15.8	16.2	22.0	22.5	60	50
KFR-1075	3/4"	20.8	21.3	26.5	27.0	75	30
KFR-1100	1"	26.4	27.1	34.0	34.5	100	30
KFR-1125	1-1/4"	35.0	35.5	42.8	43.5	135	20
KFR-1150	1-1/2"	40.1	40.6	48.5	49.0	160	20
KFR-1200	2"	50.5	51.2	61.3	62.0	190	15
KFR-1250	2-1/2"	62.9	63.6	72.1	73.0	300	10
KFR-1300	3"	77.9	78.7	87.8	88.9	450	10
KFR-1400	4"	101.6	102.6	113.2	114.3	600	5

Note:-

- All standard measurements are in United States inches unless otherwise specified.
- Metric size ID & OD will change accordingly if required please consult.
- For Aluminium - Please add KFR-1025-AL
- For Stainless Steel - 304 grade please add 34 to KFR 34-1025
- 316 grade please add 36 to KFR 36-1025



Flexible Metallic Conduit With Sealing Cord Packing (KF-1708)

This flexible metal conduit is available with a 4 types of packing materials to help increase the pressure rating of the hose and allow for vacuum applications.

Flexible metal hose, square locked, with packing flexible metal conduit flexible metal conduit

- Square-locked galvanized steel strip construction, with sealing cord packing (cotton, nylon, rubber or copper wire packed) flexible metal conduit flexible metallic conduit
- Packing for increased strength and air or moisture tightness flexible metal conduit
- High tensile strength
- Also suitable for use as ventilation or as materials conveying ductings



Galvanized Steel Strip
Helically Wound With
Nylon Chord Packing

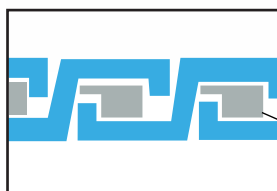

GALVANIZED STEEL STRIP

SEALING CORD PACKING:
COTTON, NYLON, RUBBER
OR COPPER WIRE



Constructed by square locking galvanized steel strip:

- Offers good mechanical protection and high tensile strength.
- With excellent crush characteristics.
- Offering a certain degree of air tightness

Applications:

Industrial wirings, appliances, automotive wire & cable sleeving, machineries, wire conduits, under floor applications – computer/floor boxes

Also suitable for ventilation applications

Features

- Increased tensile strength
- Also suitable for use as ventilation ductings

Packing Type	Pressure Range	Vaccum Rating	Temperature
COTTON	Up to 15 PSI	Up to 15" Mercury	300 F
NYLON	Up to 15 PSI	Up to 15" Mercury	180 F
RUBBER	Up to 20 PSI	Up to 20" Mercury	180 F
COPPER	Up to 15 PSI	Up to 15" Mercury	1200 F



Square locked flexible metal hose, with sealing cord packing for increased pressure and vacuum rating.

Type	Trade Size	I.D. (mm)		O.D. (mm)		Min. Bending Radius (mm)	Feet / Coil
		Min.	Max.	Min.	Max.		
KF-1030	3/8"	12.3	12.8	15.6	15.8	60	50
KF-1050	1/2"	15.8	16.2	19.5	19.9	80	50
KF-1075	3/4"	20.8	21.3	24.7	25.2	100	30
KF-1100	1"	26.4	27.1	31.6	32.1	150	30
KF-1125	1-1/4"	35.0	35.5	40.0	40.5	180	20
KF-1150	1-1/2"	40.1	40.6	45.8	46.3	220	30
KF-1200	2"	50.5	51.2	57.3	58.0	250	15
KF-1250	2-1/2"	62.9	63.9	72.1	73.1	300	10
KF-1300	3"	77.0	78.0	87.0	88.0	350	10
KF-1400	4"	99.6	101.6	108.7	110.5	400	10

- All sizes and dimensions listed above are subject to manufacturing tolerances. High Temperature Conduit
- Standard Packaging: Shrink wrapped coil. Other custom packaging methods or of longer length is also possible upon request and our approval.

Note:-

- All standard measurements are in United States inches unless otherwise specified.
- Metric size ID & OD will change accordingly if required please consult.
- For Aluminium - Please add KF-1025-AL
- For Stainless Steel - 304 grade please add 34 to KF 34-1025
- 316 grade please add 36 to KF 36-1025



Aluminum Liquid Tight Connector, Heavy Series Liquid tight Conduit Fittings

Straight connector for use with metallic and non-metallic "Type B" liquid tight conduit.

- NPT, METRIC, PG Threads Liquid Tight Conduit Fittings for Industrial Wirings
- Liquidtight, Raintight, OilTight
- Suitable for wet locations and outdoor applications
- Fixed & Swivel Types
- IP67

This line of liquid tight connectors are very easy to install. Just slip the connector onto the conduit, twist and the connector will lock onto the conduit. No need to disassemble the sealing nut first! And save your labor time!

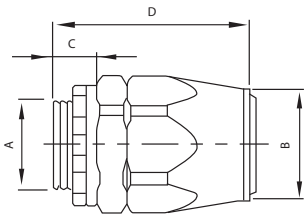

This fitting can be inserted Fixed type LT connector into a knockout and secured with a locknut. Most suitable for connecting flexible conduits to electrical boxes or enclosures.



Catalog No.	Nominal Size	Connector Dimension (mm)					Thread	Packing Pcs/Ctn
		I.D.	A	B	C	D		
KT-1030	3/8"	10.5	20.3	24.0	11.0	41.0	BSP 1/2"	50
KT-1050	1/2"	14.0	20.3	27.0	11.0	47.0	BSP 1/2"	50
KT-1075	3/4"	17.7	25.7	34.0	13.0	54.0	BSP 3/4"	50
KT-1100	1"	24.0	32.0	42.0	14.0	61.0	BSP 1"	25
KT-1125	1-1/4"	33.0	41.0	52.0	16.0	68.0	BSP 1-1/4"	20
KT-1150	1-1/2"	38.0	46.5	59.0	20.0	78.0	BSP 1-1/2"	15
KT-1200	2"	49.0	59.0	71.0	20.0	83.0	BSP 2"	10

This new line of liquid tight connectors are made of high-quality forged aluminum for superior strength and durability. These unique configurations work perfectly with our whole range of flexible conduits and hoses, especially suitable for liquidtight conduit. All forged liquidtight connectors feature: Aluminum Liquidtight Connector.

- All aluminum construction
- Anodized Finishes for increased corrosion resistant
- Totally re-useable
- Unique taper design for simple assembly and superior water tightness
- Fixed or swivel type for easy installations.

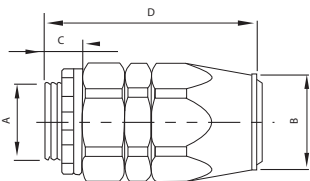

The external thread swivels about the main body. Swivel Type LT Connector It can be used with threaded entries or knockout secured with a locknut. Most suitable for installations requiring motion, vibration and bending.



Catalog No.	Nominal Size	Connector Dimension (mm)					Thread	Packing Pcs/Ctn
		I.D.	A	B	C	D		
KTR-1030	3/8"	10.5	20.3	24.0	11.0	56.0	BSP 1/2"	50
KTR-1050	1/2"	14.0	20.3	27.0	11.0	62.0	BSP 1/2"	50
KTR-1075	3/4"	17.7	25.7	34.0	13.0	69.0	BSP 3/4"	50
KTR-1100	1"	24.0	32.0	42.0	14.0	78.0	BSP 1"	25
KTR-1125	1-1/4"	33.0	41.0	52.0	16.0	88.0	BSP 1-1/4"	20
KTR-1150	1-1/2"	38.0	46.5	59.0	20.0	100.0	BSP 1-1/2"	15
KTR-1200	2"	9.0	59.0	71.0	20.0	108.0	BSP 2"	10

Braided Flexible Conduit System is widely used to counter mechanical stress and is highly flexible, and it is resistant against tensile stresses and transverse pressure. Braided flexible conduit also offers excellent protection against hot metal particles, and immunity from electromagnetic interference. Braided flexible conduits are most suitable for use in Hazardous Locations, industrial environments and high temperatures wiring applications. The high quality aluminum fittings and connectors are specifically designed to maintain the flexible braided conduit system integrity.

Interlocked liquidtight metal conduit is most suitable for frequent bending and movements. With increased IP protection when used with Liquid Tight Conduit Fittings. Liquid tight conduit offers complete protection against most liquids and moisture vapor. Resists sunlight, heat, oil and chemical degradation.

Connectors with metal clamping ring: All metal construction, most suitable for high temperature wirings. For braided flexible metal conduit and flexible steel conduit.



Trade Size								
	1/4"	3/8"	1/2"	3/4"	1"	1-1/4"	1-1/2"	2"
Part No.	KTZ1010	KTZ1030	KTZ1050	KTZ1075	KTZ1100	KTZ1125	KTZ1150	KTZ1200



Trade Size								
	1/4"	3/8"	1/2"	3/4"	1"	1-1/4"	1-1/2"	2"
Part No.	KTS1010	KTS1030	KTS1050	KTS1075	KTS1100	KLTC-1125	KLTC-1150	KLTC-1200



Trade Size								
	1/4"	3/8"	1/2"	3/4"	1"	1-1/4"	1-1/2"	2"
KT90	KLTL90-1010	KLTC90-1030	KLTC90-1050	KLTC90-1075	KLTC90-1100	KLTC90-1125	KLTC90-1150	KLTC90-1200
KT45	KLTL45-1010	KLTC45-1030	KLTC45-1050	KLTC45-1075	KLTC45-1100	KLTC45-1125	KLTC45-1150	KLTC45-1200

Note:-

- All standard measurements are in United States inches unless otherwise specified.
- Metric size ID & OD will change accordingly if required please consult.
- For Stainless Steel - 304 grade please add 34 to KTZ 34-1025
- 316 grade please add 36 to KTZ 36-1025

Kruppsmetal Corporation Consists of these Products



KRUPPSSTRUT



KRUPPSFIBER



KRUPPSTRAY



KRUPPSTRUNKING



KRUPPSFLEX



KRUPPSENCLOSURE



KRUPPSLADDER



KRUPPSCONDUIT

Middle East Marketing Office:

Delta Group

Tel : +973 17280009 / 17280200

Fax : +973 17280449

Manama, Kingdom of Bahrain

E-mail: sales@deltaelectricals.com

Web: www.deltaelectricals.com

KRUPPSMETAL Corporation.

Barnet Street, Yarravilla, Victoria 3013
Australia.

Email: sales@kruppsmetal.net
www.kruppsmetal.net